

MOON DOG WORLD

FUNCTION
PACK





Moon Dog World in Preston boasts an impressive 72 beer taps, a waterfall, lagoon, beer garden, playground, elevated sun decks and hidden pinball and games room. There is truly something here for everyone.

Our venue has five different semi-private function spaces to choose from, that can host 20 to 100 guests, as well as the option to hire our brewery floor as a private function space for 150-200 guests. We can help you celebrate birthdays, milestone events, corporate gatherings, engagement parties, laid back receptions, the options are endless.

We welcome function enquiries of any kind and handle each one on a case by case basis so please get in touch.



OUR FUNCTION SPACES



FULL TOP DECK

70–100 people

The Top Deck is our largest function area and is great for work parties and larger celebrations. It overlooks the entire venue and has options for both stand up socialising and more intimate seated events. It's accessible from either end of the area via staircases.

Semi private/TV

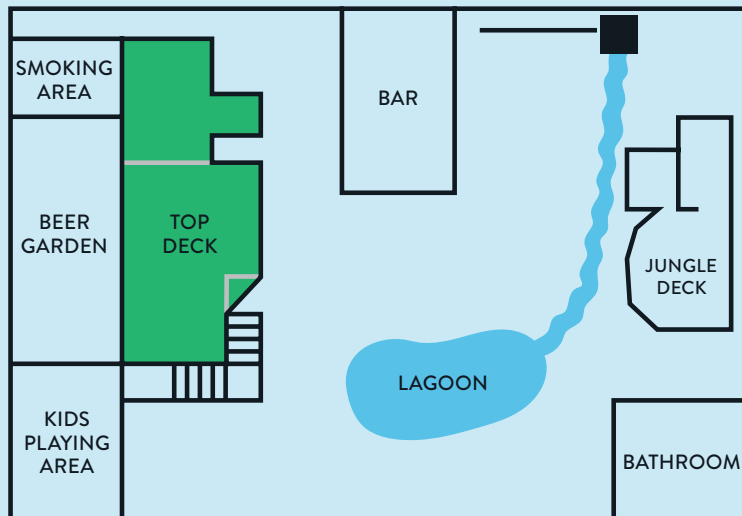

HALF TOP DECK

30–60 people

The Half Top Deck is perfect for those medium sized functions with the option of standing or seated service. It overlooks the lagoon and huge brewery windows. The Half Top Deck has its own private staircase entrance.

Semi private

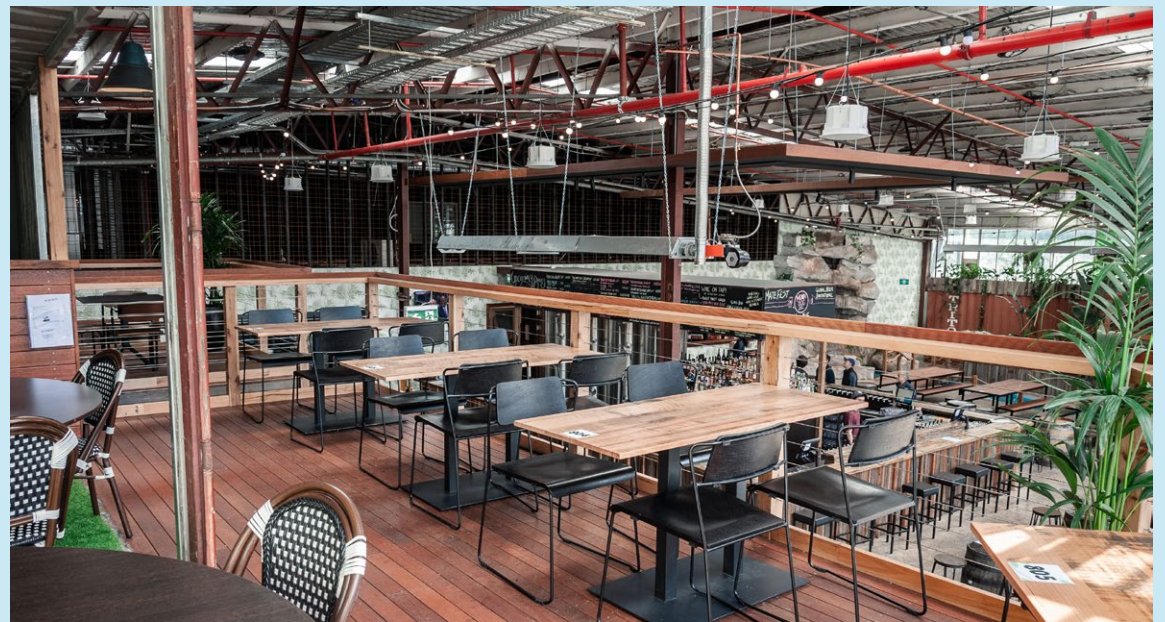
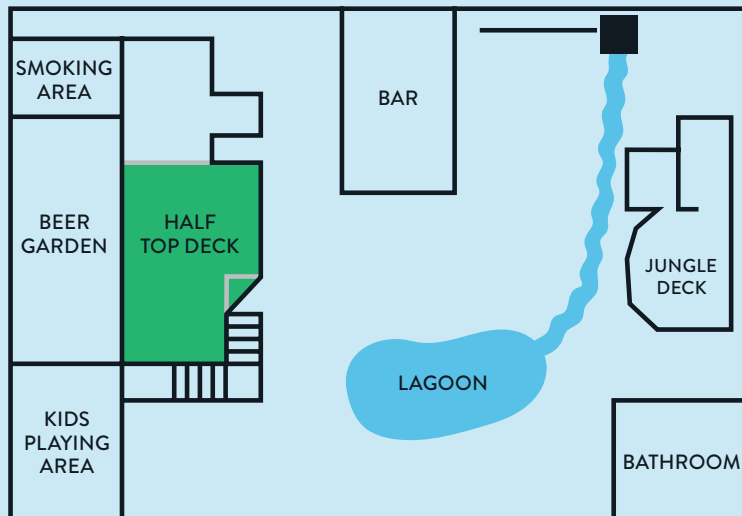

TOP DECK BOOTHS

20–40 people

The Top Deck Booths include two large diner style booths for a more intimate setting, as well as a handful of smaller tables overlooking the bar. This area boasts a 70-inch screen for presentations or slideshows and you have your own private staircase leading up to the area.

Semi private/TV

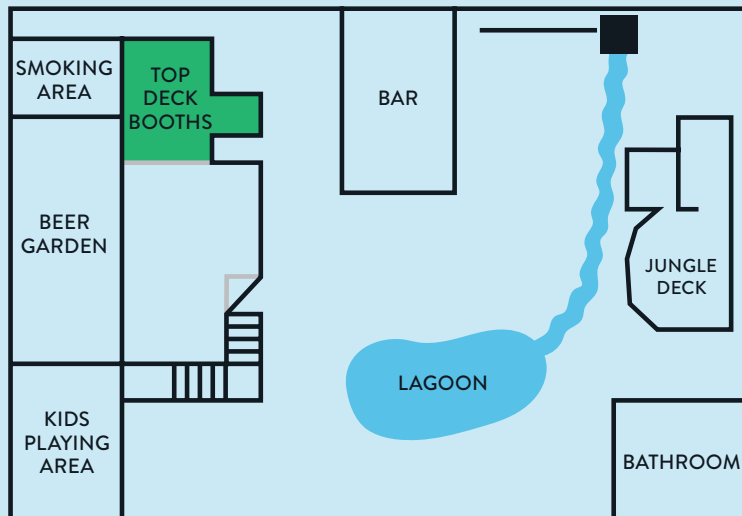

JUNGLE DECK

20–30 people

The Jungle deck is your birdseye view over Moon Dog World and the lagoon. You're surrounded by plants on your own private deck.

On Friday and Saturday nights the bottom section of the Jungle Deck is allocated to DJs which makes this the perfect VIP party area, but on weekdays the whole area is bookable which means we can accommodate slightly larger groups.

Semi private

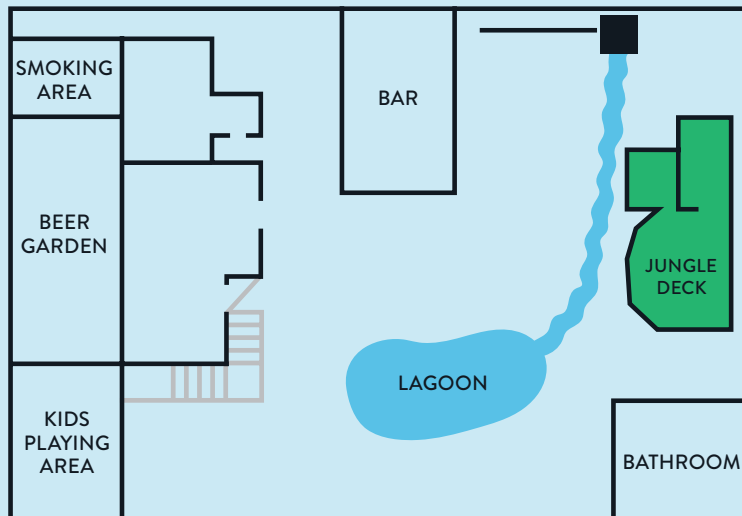

LARGE CONTAINER

20–50 people

The Large Container makes a great home base for your group. It has two booths, stool seating on the counters and the possibility to spill out onto the main bar area with the addition of barrels. It's also right next to the bar.

Semi private

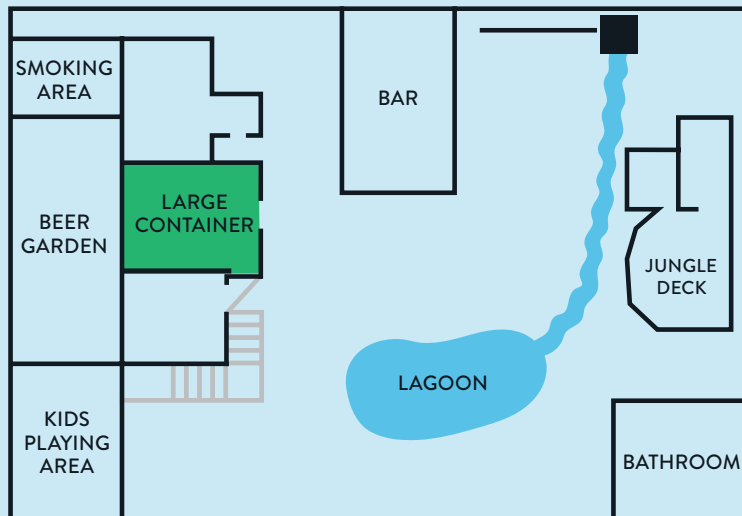
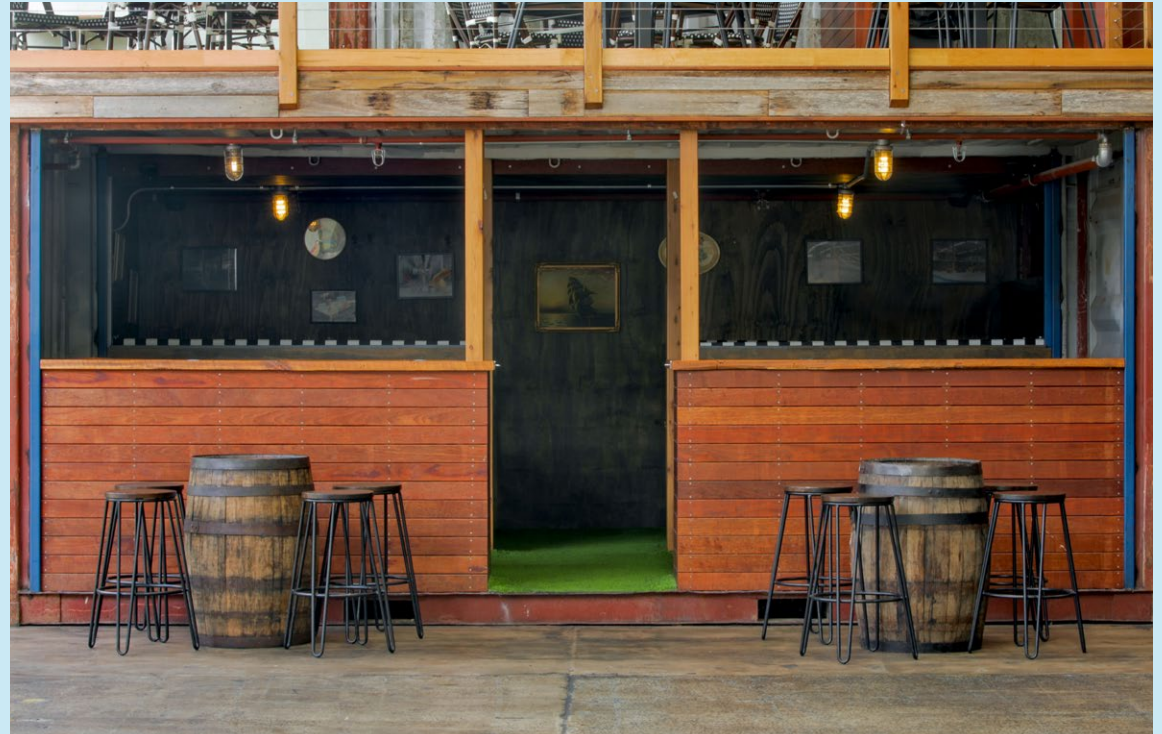

THE BREWERY

150-200 people

This private space, located right beside Moon Dog's brewhouse, exudes an industrial charm and is the perfect space for corporate events, weddings and special occasions.

Private/private bar/sit down/stand up/AV

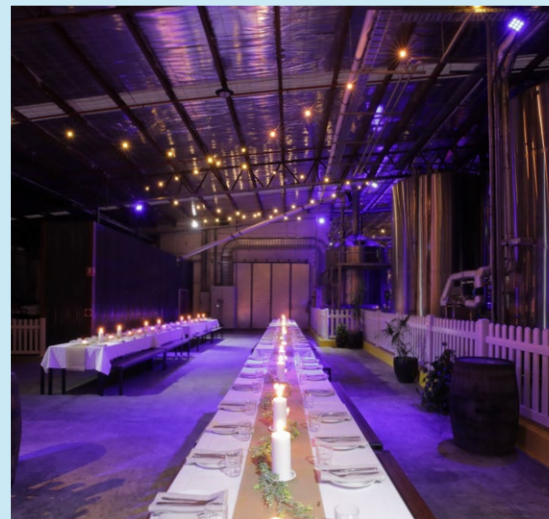
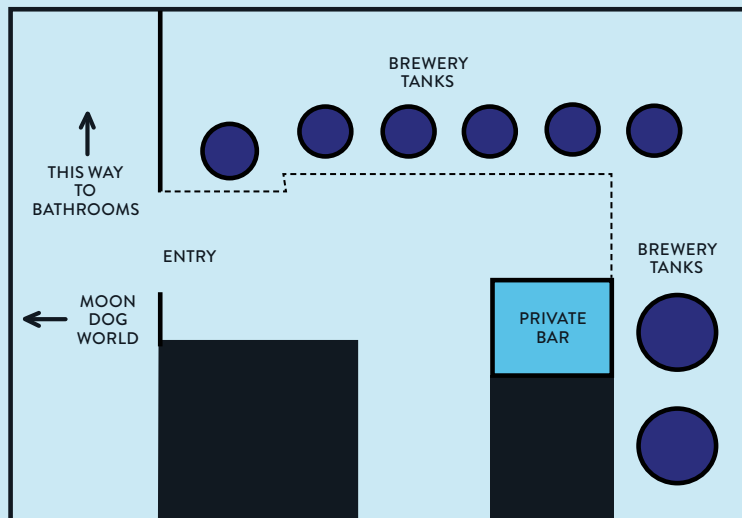

**OUR
FUNCTION
PACKAGES**



CANAPES

PER PERSON PACKAGES

MINIMUM 20 PEOPLE

Option 1

5 Smaller Bites \$30 pp

Option 2

2 smaller bites + 2 bigger bites \$30 pp

Option 3

3 smaller bites + 3 bigger bites \$45 pp

Option 4

4 smaller bites + 4 bigger bites \$60 pp

Add a sweet bite for \$6 pp

INDIVIDUALLY PRICED ITEMS

MINIMUM ORDER OF 20 EACH

Smaller bites \$7 each

Bigger bites \$10 each

Sweet bites \$6 each



CANAPES MENU

SMALLER BITES

Haloumi bites, honey, dukkah (v, gf)

Cheeseburger spring roll

Mac and cheese croquette (v)

Pulled chicken tostada, tomatillo salsa,
frijoles, sour cream (gf)

Pulled jackfruit tostada, salsa, frijoles (v, vg, gf)

Freshly shucked oyster, classic mignonette (gf)

Vegetable empanada (vg)

Crispy cauliflower bites, spicy mayo,
pickles (v, vgo, gf)

BIGGER BITES

Crispy buffalo chicken ribs, spicy mayo,
celery (gfo)

Beef slider, tomato, lettuce, pickles,
burger sauce (gfo)

Vegan slider, tomato, lettuce, pickles,
burger sauce (vg, gf)

Crispy chicken slider, creamy slaw, pickles,
house-made BBQ sauce

Pork and fennel sausage roll

Roasted vegetable sausage roll (vg)

Chunky steak and ale pie

Pulled shiitake mushroom hard shell taco,
apple slaw, coriander (vg, gf)

Pulled pork hard shell taco, apple slaw,
coriander (gf)

SWEET BITES

Classic vanilla slice, flaky puff pastry,
vanilla custard (v)

Chocolate brownie, chocolate cream (v,gf)

Churros bites, chocolate sauce (v)

Vegan peanut slice (vg)

*Our menus change seasonally; substitutions may be made. (gf) gluten free (gfo) gluten free optional (v) vegetarian (vg) vegan (vgo) vegan optional.

SEATED SHARING

PER PERSON PACKAGES

MINIMUM 20 PEOPLE

Prefer a sit-down meal? We offer a sharing menu perfect for long lunches and special dinners. Sharing menu functions are served family style and are located on our main floor on long tables, perfect for groups of 20–80 people.

Entrees / Mains / Sides \$65 pp

Mains / Sides / Desserts \$65 pp

Entrees / Mains / Sides / Desserts \$75 pp



SEATED SHARING SAMPLE MENU

STARTERS	MAINS	SIDES	SWEET
<p>Olives Marinated Spanish olives (vg)</p> <p>Chimichurri white bean dip Chili lime seasoning, coriander, pepitas, tortilla chips (gf)</p> <p>Smoked salmon Pomegranate & pistachio salsa (gf)</p>	<p>Slow cooked chermoula lamb shoulder Roquette (gf)</p> <p>Chili & lime roasted chicken Roquette, charred lime (gf)</p> <p>Roasted pumpkin, rojo mojo, endive salad (gf)</p>	<p>Cos leaf salad Buttermilk dressing, radish, fresh dill (gf)</p> <p>Lemon & oregano roasted kipfler potatoes (gf, vg)</p>	<p>Candied orange cake Berry compote (gf)</p> <p>Chocolate brownie Chocolate cream (gf)</p>

*Our menus change seasonally; substitutions may be made. (gf) gluten free (gfo) gluten free optional (v) vegetarian (vg) vegan (vgo) vegan optional.



CAPTAIN'S PICK

Not too sure on exact numbers or just looking to take all of the fuss out of your function? Choose one of our pre-made packs for group sizes of 8-40. We'll serve you up a selection of dishes to keep your guests happy (think tacos, dip, potato gems and cheese burger spring rolls) and they'll get a drink on arrival included. Most dietaries are pre-catered for and you'll get an extended booking time of 3 hours, perfect for partying the night away.



\$500	\$1,000	\$2,000
8-15 guests	15-25 guests	25-40 guests
6 food items	9 food items	9 food items
1 drink per person	1 drink per person	1 drink per person

You can add on a bar tab or drinks package to any of these options.

DRINK PACKAGES

EASY DRINKING

Beer & Cider

Moon Dog Draught
Moon Dog Old Mate Pale Ale
Moon Dog Cider

Seltzer & Boozy Pub Classics

All Fizzer Seltzers

Wine

House sparkling
House white
House red

Non-alcoholic

Soft drinks
Juices
Non-alcoholic beer

Gluten-free beer

\$60 pp 3 hours
\$75 pp 4 hours

PARTY PACK

Beer & Cider

Moon Dog Draught
Moon Dog Old Mate Pale Ale
Moon Dog Pacific Ale
Moon Dog XPA
Moon Dog Cerveza
Moon Dog Cider

Seltzer & Boozy Pub Classics

All Fizzer Seltzers
Boozy Ginger Beer
Boozy Pub Squash

Alcoholic Slushies

Limoncello Slushie
Piña Colada Slushie

Wine

House sparkling
House white
House red

Non-alcoholic

Soft drinks
Juices
Non-alcoholic beer

Gluten-free beer

\$70 pp 3 hours
\$80 pp 4 hours

THE LOT

Beer & Cider

All Moon Dog tap beers
Moon Dog Cider

Seltzer & Boozy Pub Classics

All Fizzer Seltzers
Boozy Ginger Beer
Boozy Pub Squash
All other rotating pub classics

Alcoholic Slushies

Limoncello Slushie
Piña Colada Slushie

Basic Spirits

Vodka, Gin, Rum, Whiskey,
Bourbon, Tequila.

Wine

All wine by the glass

Non-alcoholic

Soft drinks
Juices
Non-alcoholic beer

Gluten-free beer

\$90 pp 3 hours
\$105 pp 4 hours

BAR TAB

On consumption bar tab with
specified limits can be set up
if you prefer.



ADD ONS

Cocktail on arrival

Aperol Spritz \$15 pp
Espresso Martini \$15 pp

French Champagne

\$120 per bottle

Shot trays

A selection of signature
Moon Dog shots. \$8 per shot. (minimum 20)

Private waitstaff

\$55 per staff per hour

Got something else in mind?

Just ask.
We'll do everything we can to make it work.



SOME ANSWERS TO YOUR QUESTIONS!

How long is my function?

Functions are a standard 4 hours, but you are more than welcome to extend your function if there is availability.

Is my space private?

Our spaces are semi-private and are a part of our whole venue. That means your space is reserved just for you, but you'll be using the same bar, bathroom facilities, etc as the rest of the venue. The brewery space is private with its own bar and music, the bathroom facilities remain shared with the venue.

Do you have alcohol other than beer?

Of course we do. Our bar is stocked with our Fizzer seltzers, wines, and spirits and non-alcoholic beverages.

How much does a function cost?

Costs depend on the space, day and length you would like to book. Get in touch to discuss.

Can kids come?

Children are more than welcome to attend our venue. All children under the age of 18 must be accompanied by a parent, guardian, or responsible adult.

Persons under the age of 18 are asked to leave the venue at 10pm.

Can I play my own music?

As our function spaces are semi-private and part of the whole venue, we are unable to play separate music for functions. This also means we cannot have outside entertainers (such as clowns, magicians, etc). We play music that appeals to everyone and have DJs every Friday and Saturday night.

Functions in the brewery space can have their own music and entertainment, in the past we've had bands, DJs and live performers.

Not quite what you were looking for? Check out our other venues around Melbourne that offer a wide variety of unique spaces, capacities and food and drink options.

Moon Dog OG (Abbotsford)



Moon Dog Beach Club (Frankston)



Moon Dog Doglands (Docklands)

Moon Dog Wild West (Footscray)





MOON
DOG
WORLD

Want to find out more?

Get in touch with our functions team

functions@moondog.com.au

(03) 9428 2307

