

VENUE HIRE

Capacity: 120 pax standing & 60 seated

Furniture:

6 bar tables + 18 stools

3-seater yellow couch

5-seater charcoal corner couch

1-seater cane armchair

Assorted cushions and ottomans

AV:

Surround sound speakers

TV screen (HDMI & USB connection)

4 uplights (bar use only)

Amenities include: Private bar, Dance floor, 2 unisex bathrooms

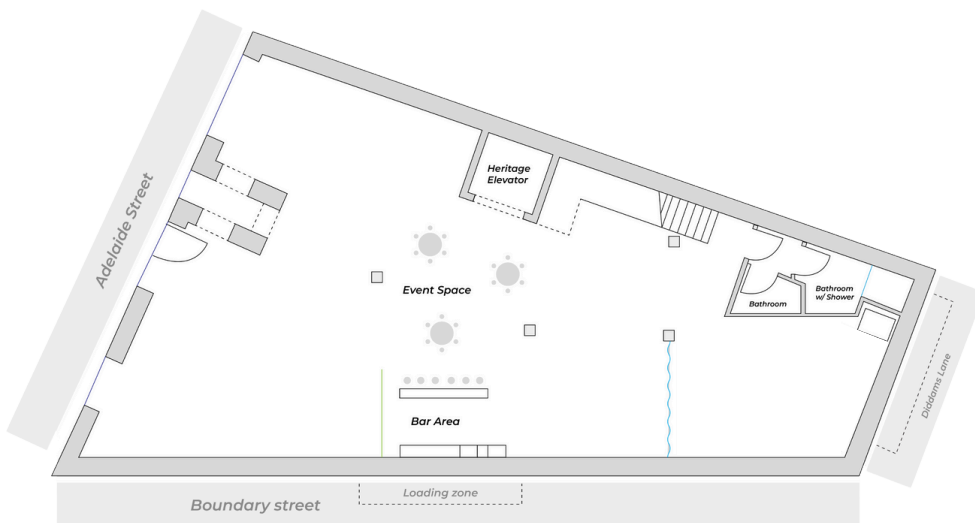



Floor Plan

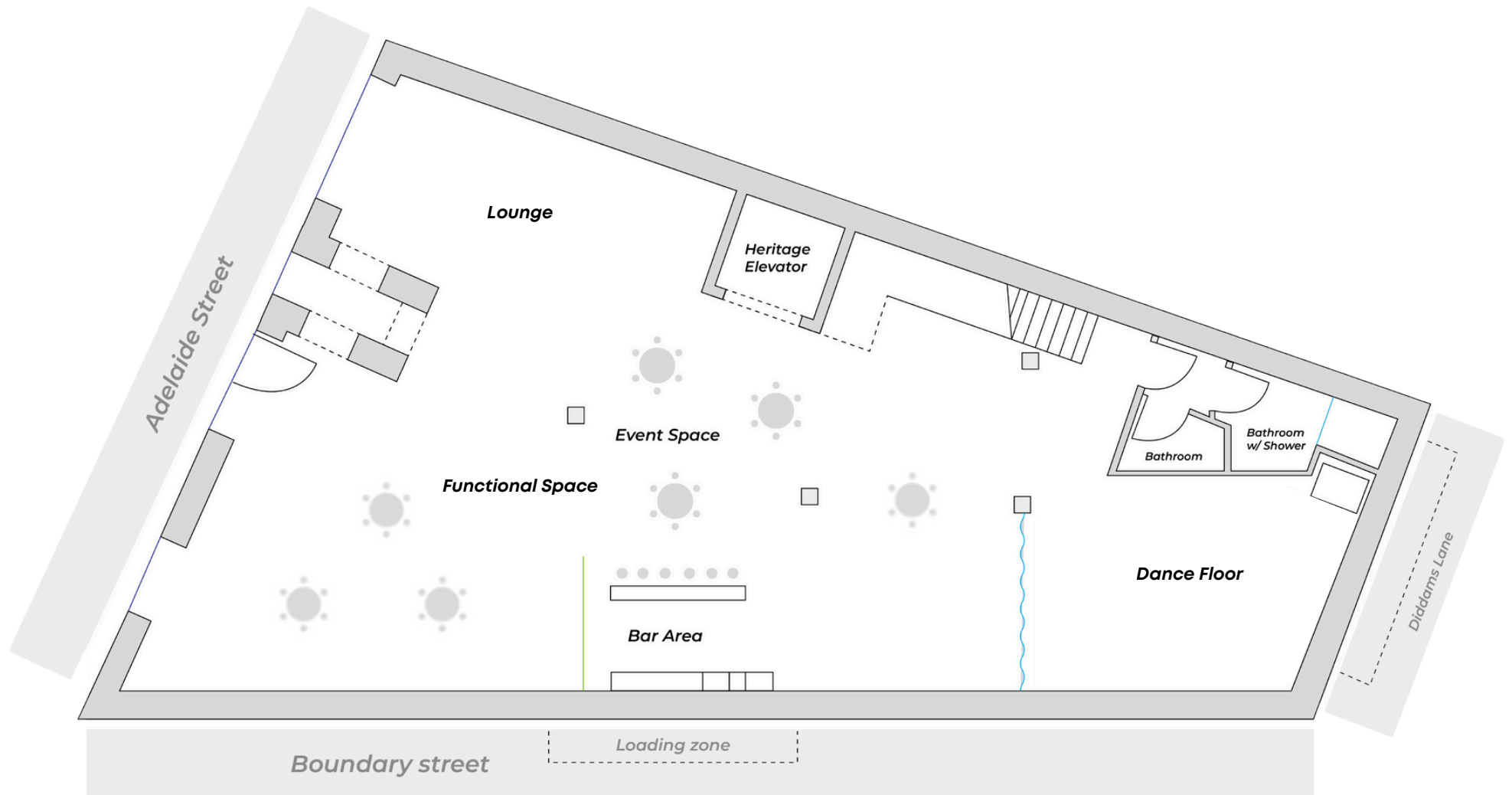



Inclusions

- Exclusive venue hire for 4 hours, additional hour for \$300.
- All onsite furniture
- On-the-day coordination with your event coordinator
- Bar service staff
- 1 - hour bump in period
- 30 minute bump out period

	Weekdays	Fri	Sat	Sun
Venue hire	\$900	\$1,100	\$1,300	\$1,000
Min. Bar Spend	\$1,500	\$2,000	\$2,000	\$2,000

Bespoke Packages available at request.

Sunday Public Holidays Pricing and availability are subject to change. All prices inc. GST



BEVERAGE PACKAGES – Optional

Choose from our premium beverage packages, including unlimited beer, wine and soft drinks.

	Silver	Gold
3-hour package	\$60	\$70
4-hour package	\$70	\$75

What's included: Silver Package

BTW Prosecco
BTW Sauvignon Blanc
BTW Pinot Grigio
BTW Pinot Noir

Two Local beer options
Somersby Apple cider

What's included: Gold Package

In addition to what's included in the silver package, you're able to upgrade 2 wines and choose 2 additional beers from the below list.

Fantini Cerasuolo D'abruzzo Rosè 2021
Pinot Grigio Delle Venezie 2021
M by Mandala Sparkling

Choose to upgrade to include unlimited spirits:

\$20 pp/per hour for Basic 'House' Spirits

\$35 pp/per hour for premium spirits



BAR MENU

Set up a bar tab or have your guests pay for some drinks. Our carefully curated bar tab options are designed to cater to diverse tastes and preferences. A standard tab includes 4 beers and cider, 5 choice spirits, 3 choice wines and cocktails.

BEER

Revel Pale Ale - 5%	\$13
Somersby Cider Apple 4.0%	\$12
Revel Session Ale - 3.5%	\$12
Corona Extra	\$12
Revel Hazy IPA - 6.5%	\$17

WINE

VIC 2022/23 BTW Sauvignon Blanc	\$12/\$60
VIC 2022/23 BTW Pinot Grigio	\$12/\$60
VIC 2022/23 BTW Rosè	\$12/\$60
VIC 2022 BTW Pinot Noir	\$12/\$60
VIC 2022 BTW Shiraz	\$12/\$60
VIC 2022/23 BTW Prosecco	\$12/\$60

PREMIUM WINES

VIC 2022/23 Zilqie Chardonnay	\$60
FRA Verve Cliquot Yellow Label Brut	\$185
FRA Moet and Chardon Imperial Brut	\$160
FRA Moet and Chardon Imperial Brut Magnum	\$360

COCKTAILS

Espresso Martini	\$24
Amaretto Sour	\$24
Tommy's Margarita	\$24
Cosmopolitan	\$24

HOUSE SPIRITS

CASA Vodka	\$12
CASA Silver Agave	\$12
CASA Dry Gin	\$12
CASA Dark Rum	\$12
CASA Burbs Whiskey	\$12

PREMIUM SPIRITS

Grey Goose Vodka	\$14
Patron Silver Tequila	\$14
Tanqueray Gin	\$14
Bacardi White Rum	\$13
Sailor Jerry Spiced Rum	\$13
Chivas Regal 12Yo Scotch	\$17
Jack Daniels Bourbon	\$13.5

NON-ALCOHOLIC BEVERAGES

Add Red Bull to any spirit purchase	\$3
Add Juice - Cranberry, Pine-Orange	\$1.50
Redbull Single	\$7
Large Soft Drink	\$5
Small Soft Drink	\$3.5

SHOOTERS

The W.A.P	\$10
Guava Kiss	\$10
Kamikaze	\$10
Caramel Latte	\$10

If you would prefer a different set up bar tab or a different alcohol selection, please talk to our friendly team!

Please note our menus are subject to change, your event co-ordinator will provide you with an updated menu 2 weeks prior to your event.

BESPOKE ADDITIONS

Elevate your experience with our bespoke additions, designed to unlock the full potential of eSpace and ensure your event unfolds seamlessly. Please note, all additions are subject to availability and require ample notice for preparation.

PREMIUM CUSTOM BAR MENUS - ACRYLIC	\$175
CUSTOM BAR MENU - FRAMED	\$90
CUSTOM INVITATIONS PRINTING	\$250 POA
CUSTOM STENCILS FOR COCKTAILS	\$300
PHOTOGRAPHER AND HIGHLIGHT REEL	\$850
CUSTOM BAR SIGN (INC. DESIGN)	\$350
EARLY BUMP IN (ADD. 2 HOURS)	\$200
CLOAK ROOM SERVICE	\$500
CAKEAGE	\$5/ GUEST
OVERNIGHT STORAGE – CAKE AND DECORATIONS	\$400
PROJECTOR AND SCREEN	\$150
WIRELESS MICROPHONE	\$75 EA.
FULL EVENT MANAGEMENT AND VENDOR COORDINATION	\$1,500





RECOMMENDED SUPPLIERS

CATERING PARTNER	<u>Boheme Events</u>
PHOTO BOOTH	<u>360 Booth</u>
PHOTOGRAPHY & VIDEOGRAPHY	<u>RECAP MEDIA</u>
PHOTO BOOTH (LEFT)	<u>Getaphotobooth</u>
INDOOR FIREWORKS	<u>G&M Event Group</u>
DJ AND LIGHTING	<u>G&M Event Group</u>
CHAMPAGNE TOWER (PAGE 6)	<u>Champagne Tower</u>
EVENT STYLING (PAGE 8)	<u>Event Styling Brisbane</u>
FLORALS	<u>Gloriosa Florals</u>
CAKE	<u>The Sweet Society</u>

FAQ'S

Closing time

The latest our venue can serve alcohol is 12 am

Do I need security?

Security isn't always required, but depending on the type of event and expected guests, we may ask that you arrange security

Is there a bond?

There is a refundable \$1000 bond to be paid directly to eSpace within 7 days to your event.

I see there's another level upstairs, can I access this?

This is our team's office, and is off-limits for all guests. Unauthorised access to this floor will result in an instant loss of bond.

Should I leave a review?

We'd love to hear about your experience with us at eSpace.

Cancellations

In the event of any cancellations or change of date all payments will be forfeited, so please ensure everything is confirmed before proceeding with booking with us.

Public Transport

eSpace is a short 800 m walk from both Brisbane Central and Fortitude Valley train Stations.

Adelaide St - Stop 31 and Ann St - Stop 220 are our closest bus stops, just a short 120 m walk from our venue's door.

Howard Smith Wharf ferry terminal is only a 700 m walk.

Can I supply my own food and beverage?

eSpace is partnered with Boheme Events for all catering within our venue, we're confident they'll exceed your expectations. If for any reason you'd to to engage with your own onsite catering vendor there is a \$300 onboarding fee payable by the hirer to the venue.

Is eSpace a BYO Venue?

As eSpace is not a BYO licensed venue, no alcoholic drinks can be brought in.

Can I supply my own cake?

Absolutely! We have no extra costs associated with bringing in your own cake. Please note you'll need you'll provide your own napkins and cutlery if required.

Can I bring my own decorations?

You can customise eSpace however you'd like! All decorations and styling must be removed after your event or a \$500 pack down fee will be deducted from your bond. To organise a time to start setting up prior to your event please contact your events coordinator.

Parking

There is no onsite parking provided by eSpace, however The Howard Smith Wharves Carpark is just a 2 minute walk away.

Hotels Nearby

Situated in Brisbanes CBD there are an abundance of hotels nearby. We have discount partnerships with the Marriot and Hotel X, two nearby hotels.