

THE FACILITY | PURNELL'S LOFT

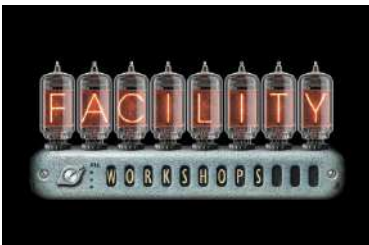

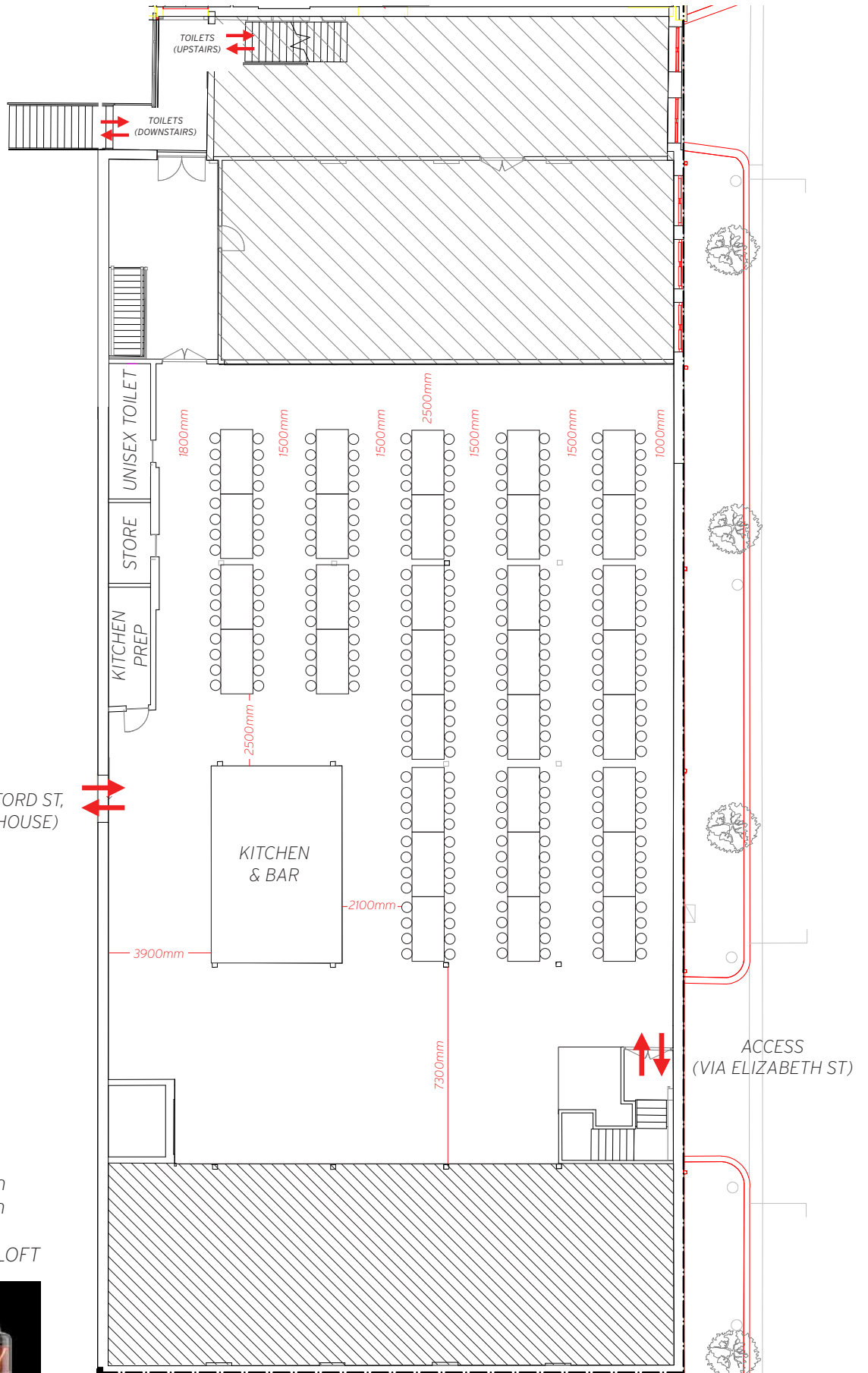

ACCESS
(VIA REAR CHEMSFORD ST,
THROUGH GREENHOUSE)

ACCESS
(VIA ELIZABETH ST)

FURNITURE

32 TRESTLES @ 2.4m x 1.2m
256 CHAIRS @ 0.4m x 0.4m

THE FACILITY | PURNELL'S LOFT



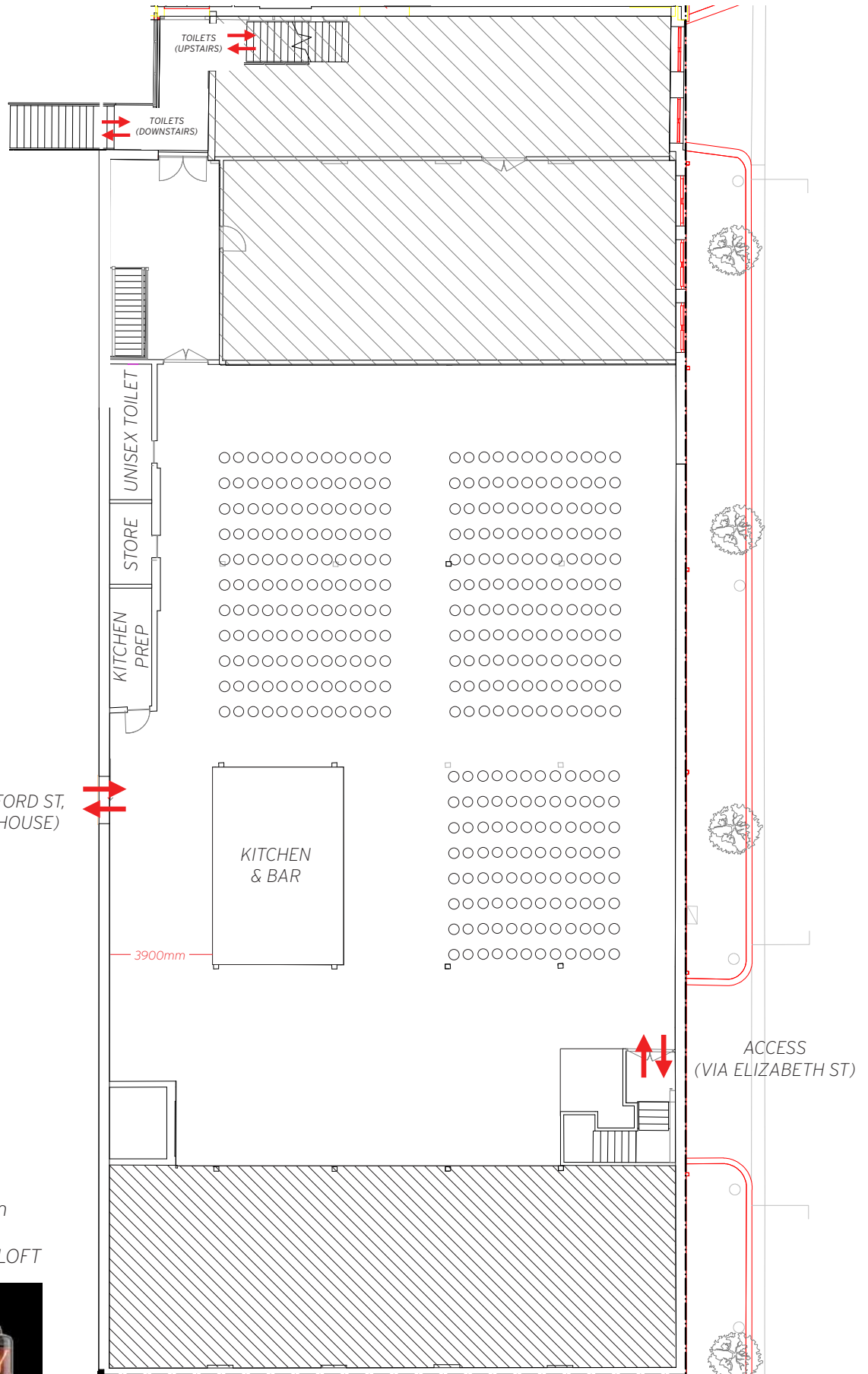

ACCESS
(VIA REAR CHEMSFORD ST,
THROUGH GREENHOUSE)

3900mm

ACCESS
(VIA ELIZABETH ST)

FURNITURE
360 CHAIRS @ 0.4m x 0.4m

THE FACILITY | PURNELL'S LOFT

